

BEFORE YOU BEGIN



- Do not use with water that is microbiologically unsafe or of unknown quality
- The system must be protected from freezing
- For cold water use only
- Installation should be carried out by a competent person with previous plumbing experience
- All installations should comply with local bylaws

For System Installation, follow Section A, then B.

For Cartridge Replacement, follow Section B.

WHAT'S INCLUDED



Complete Filter System (SPECTRUM Drinking Water Inline Taste System or SPECTRUM Water Mineraliser Side Tap System)

1. Inline Filter Cartridge
2. ¼" Tubing (2 x 1m)
3. Inline Filter Cartridge Clips (x2)
4. Self-piercing Saddle Valve
5. Mini-Tap and Fitting



A FULL SYSTEM INSTALLATION



Determine the position of the drinking water mini-tap to ensure that the tubing will reach between the filter cartridge and the mini-tap. The mini-tap should be positioned on the sink itself or an adjacent worktop, where water can be dispensed into the basin.

Tap Installation

1. To install the mini-tap, drill a ½" (12mm) hole through the sink or worktop for the threaded part of the mini-tap. Ensure to use the necessary tools and protection to prevent damage to any surfaces.

Note: the mini-tap is designed to suit worktops up to 35mm in depth. During installation, modifications to the worktop may be required for worktops >35mm.

2. Slide the thread of the mini-tap through the base plate of the tap and then through the sink or worktop. (Image 1)
3. From under the sink or worktop, place the black washer over the thread of the mini-tap and fix in place with the mini-tap locking nut. (Image 2, 3)
4. Remove the blue locking clips from the white push-fit fitting and install the fitting on to the end of the tap thread. (Image 4, 5)
5. Connect an end of the blue tubing to the white push-fit fitting. Ensure the tubing is firmly installed, which can be tested by pulling the tubing once installed. (Image 6)
6. Replace the blue locking clips on to the push-fit fitting. (Image 7)

Saddle Valve Assembly

1. Place the brass nut, over one end of the red tubing. (Image 8)
2. Push the white plastic olive over the same end and then push the plastic tubing insert into the end of the red tubing. (Image 9, 10)
3. Connect the brass nut to the saddle valve and tighten to prevent leaks. **Do not overtighten.** (Image 11, 12)



(Image 1)



(Image 2)



(Image 3)



(Image 4)



(Image 5)



(Image 6)



(Image 7)



(Image 8)



(Image 9)

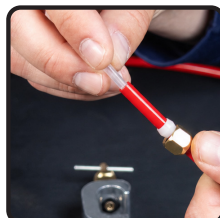

(Image 10)

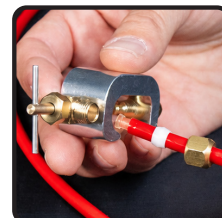

(Image 11)

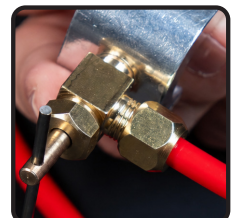

(Image 12)

A FULL SYSTEM INSTALLATION



Saddle Valve Installation

1. Turn the main water supply off and open an existing outlet to relieve pressure.
2. Place the saddle valve over the copper feed water pipe and ensure the saddle is seated as shown in *Image 15* with the wider block diameter facing upwards for 1/2" or 15mm piping.
3. Tighten the screw at the bottom of the saddle valve to clamp tightly onto the feed water pipe. (*Image 14, 15*)
4. Twist the handle at the top of the saddle valve clockwise, to pierce a hole through the feed water pipe and leave in this position. (*Image 16*)

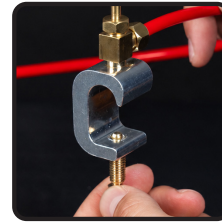

(Image 13)

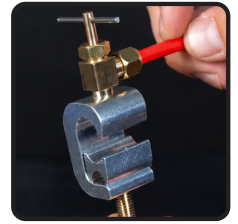

(Image 14)

Cartridge Installation

1. Mount the inline filter cartridge clips in a suitable position, using appropriate fixings for the wall substrate. *Check the length of tubing available and the distance between the saddle valve and the mini-tap.* (*Image 17, 18*)
2. Follow **Section B - Cartridge Install/Replacement Steps 6-9** then proceed to **System Start Up.**

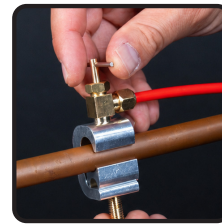

(Image 15)

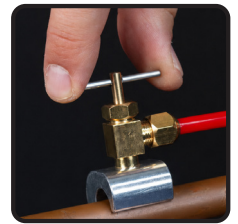

(Image 16)

System Start Up

1. Open the mini-tap
2. Turn the main water supply on.
3. Slowly unscrew the handle on the saddle valve (no more than 7 turns) to allow water to flow through the system. (*Image 16*)
4. Allow air to purge from the system and once water begins to flow through tap, run water for several minutes until clear.
5. Close the mini-tap and check installation for leaks.

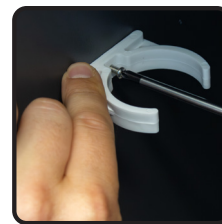

(Image 17)



(Image 18)

B CARTRIDGE INSTALL/REPLACEMENT



1. Turn off the main water supply to the system.
2. Open the mini-tap to drain residual water in the tubing.
3. Place a bucket or small bowl under the cartridge to catch any additional water.
4. Disconnect the red and blue tubing from the cartridge. This can be done by pressing down the white collar (collet) around the tubing going into the cartridge, whilst at the same time pulling the tubing. (*Image 19*)
5. Remove the inline cartridge from the cartridge clips and dispose of, according to local guidelines. (*Image 21*)
6. Remove the new cartridge from its packaging and check for any obvious damage.
7. Connect the other end of the red tubing (connected to the saddle valve) to the inlet of the inline cartridge. *Check the direction of flow through the cartridge.* (*Image 19*)
8. Push the cartridge into the cartridge clips to mount in position. (*Image 21*)
9. Connect the other end of the blue tubing (connected to the mini-tap) to the outlet of the inline cartridge. *Check the direction of flow through the cartridge.* (*Image 20*)
10. Turn the main water supply on.
11. Allow air to purge from the system and once water begins to flow through the mini-tap, run water for several minutes until clear.
12. Close the mini-tap and check installation for leaks.



(Image 19)



(Image 20)



(Image 21)

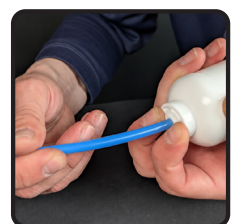

(Image 22)