

INSTALLATION INSTRUCTIONS

IMPORTANT PRECAUTIONS AND INSTRUCTIONS

The product is suitable only for connection to a cold-water or mixing-water facility. The maximum allowable operating temperature is 60°C (122°F). The maximum allowable operating pressure of the filter system is 5 bar (72.5 psi). Contact your water supplier or your technical department for information about the current water pressure.

Make sure that the tap filter is connected correctly by carefully following these operating instructions. Do not use if the package has been damaged, or after the expiry date has passed. Wash your hands thoroughly before installation. Avoid contact with the outlet opening of the filter as much as possible to prevent bacterial contamination. During periodic disinfection of the water supply system, the filter does not have to be removed. Depending on the disinfection method used, the filter may have to be replaced afterwards.

Please refer to the filter data sheet for this. Avoid exposure to temperatures below 0°C after first use. Handle with care, do not expose to shocks; this may damage the filter material. When in doubt, replace with a new filter cartridge.

INSTALLATION OF THE TAP FILTER

- 1** Where required, remove the aerator of the tap.
- 2** Remove the Tap Filter from the packaging.
- 3** Fit the flow regulator in the designated opening. The arrow on the regulator indicates the flow direction. Press the regulator into place, and then fit the flat gasket.
- 4** Screw the Tap Filter onto the tap opening. The Tap Filter comes standard with a 22mm coupling (inner thread). Adaptors for other sizes are available. Make sure that the flat seal of the coupling is in the correct position. Click the Tap Filter into position.
- 5** Attach the waterproof 2-part date label supplied, to the filter and write down the date of first use and the replacement date on both labels. The top label is for your own administration.

Attach the bottom label to the filter. If you have instrument management software the filter can be registered via the bar code.

The Tap Filter can now be put into use.



1

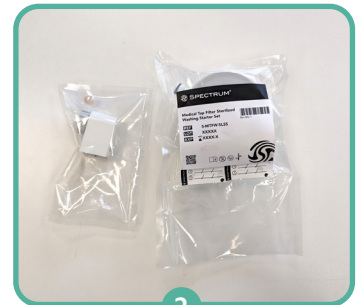

2



3

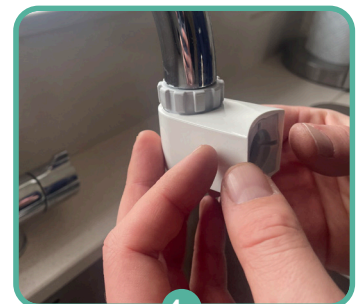

4a



4b

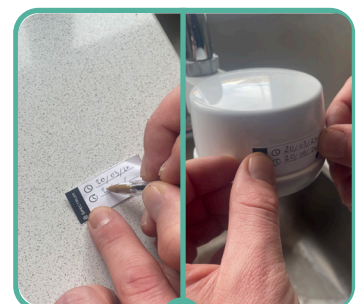

5

REPLACING THE FILTER CARTRIDGE

The filter must be replaced no later than 92 days after it was used for the first time. Replace the cartridge in any case if the water pressure is noticeably reduced. If the filter needs to be replaced early, this is generally not a result of a defect in the tap filter, but rather an indication that the quality of the incoming water is inferior or that this tap is being used more than average.

FOLLOW STEPS 1-5 TO REPLACE THE CARTRIDGE

- 1 Remove the used cartridge from the coupling using the grey tool supplied. The non-return valve ensures that no contaminated water can flow out of the cartridge. A small amount of mains water may flow out of the coupling. The used cartridge is sealed and can be disposed of as regular waste.
- 2 Remove the filter cartridge from the packaging.
- 3 Then place the new cartridge into position by pushing it onto the quick-connect coupling until you hear a click and the cartridge is firmly connected.
- 4 Attach the waterproof 2-part date label supplied, to the filter and write down the date of first use and the replacement dates on both labels. The top label is for your own administration.
- 5 Attach the bottom label to the filter. If you have instrument management software the filter can be registered via the bar code.

1

2

3

4

5